

$\text{Ø}0.5625''^{+0.002}_{-0.000}$

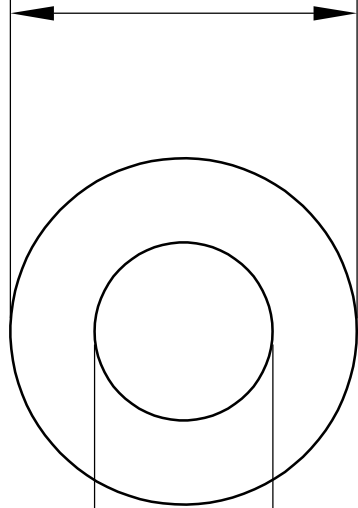

$1/2'' \pm 0.005$

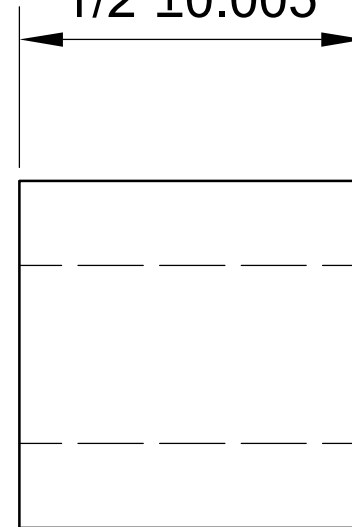

$\text{Ø}0.375''^{+0.002}_{-0.000}$

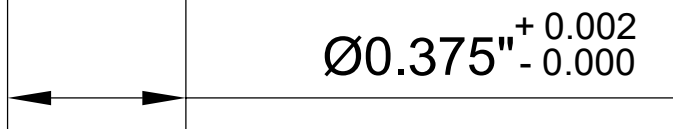

LILY[®]

SHANGHAI LILY BEARING LIMITED

Email: lilybearing@lily-bearing.com

Part
Number

2803T14 Chemical-Resistant
Dry-Running PEEK Sleeve Bearing